

# CERTIFICATE OF LOCATION OF GOVERNMENT CORNER

EAST QUARTER Corner of Section 5, Township 107, Range 39, 5th P.M.

STATE OF MINNESOTA, County of MURRAY

At the corner location shown on the sketch:

- On DEC.24/1991 found a nothing was ever found  
DATE
- left monument as found,  lowered monument,  removed monument (explain)
- On DEC.24/1991 placed a 5/8" rerod w/seal  
DATE

### SKETCH OF REFERENCE TIES

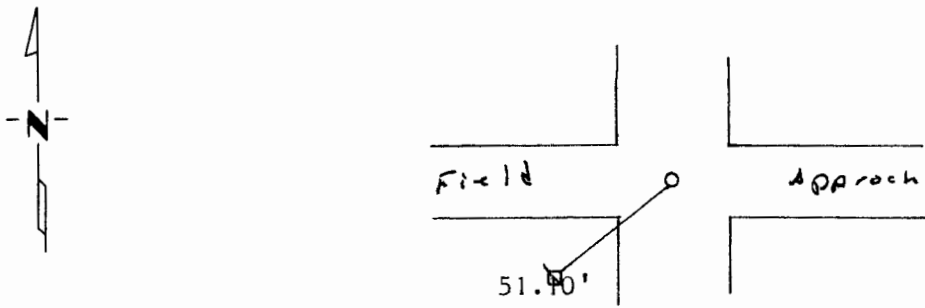

Nail and seal in power pole SE. 51.10'

I set rerod by proportional method it is in the centerline of road and in line with fence to the west.

Statement of evidence relative to this corner location is on back of page.

I hereby certify that this document and the data contained herein was prepared by me or under my direct supervision.

Archie E. Mooney Jan 13, 1991  
SIGNATURE DATE  
 Registration No. 11943  
 Land Surveyor,  Professional Engineer  
 County Surveyor,  County Engineer

#### OFFICE OF THE COUNTY RECORDER

County of \_\_\_\_\_  
 I hereby certify that this document was filed in the Co. Recorders office at \_\_\_\_\_ .M. on the \_\_\_\_\_ day of \_\_\_\_\_ A.D., 19 \_\_\_\_  
 County Recorder \_\_\_\_\_  
 By \_\_\_\_\_, Deputy  
 DOCUMENT NO. \_\_\_\_\_

Statement of Evidence:

Original survey done Aug.9--Sept.2, 1861 by Lewis Brochman  
Set pit and mound.

1978 Murray county Highway department dug with a back hoe and  
found nothing.

December 24, 1991 I set a 5/8 inch rerod with seal on line  
between the section corners and proportionate between the  
section corners.

SOUTHEAST CORNER TO EAST QUARTER CORNER

$$\begin{array}{l} \text{Original} \\ \text{Original} \end{array} \quad \frac{2640}{5183.64} \quad \frac{x}{5228.78} \quad x = 2662.99$$

EAST QUARTER CORNER TO NORTHEAST CORNER

$$\begin{array}{l} \text{Original} \\ \text{Original} \end{array} \quad \frac{38.54 \text{ chains}}{78.54} = \frac{2543.64'}{5183.64'} \quad \frac{x}{5228.78'} \quad x = 2565.79'$$